

Flanges

DN32 – DN200

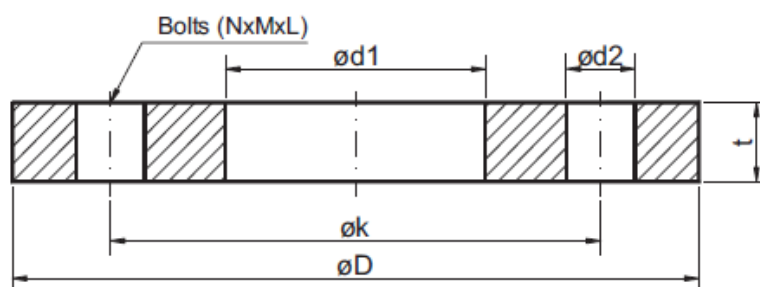

Stock no. 95011

Description:

Flanges of thickness 10 (16)mm
Dimensions according to DIN 2576

Material:

- S235JRG2

Tolerance of $\varnothing d1$:

- <100 mm +0,5
- >100 - 200 mm +1

Stock No.	Pipe		Flange			Bore and bolts			Weight [kg]
	ND	Dia. [mm]	$\varnothing D$ [mm]	$\varnothing d1$ [mm]	t [mm]	$\varnothing d2$ [mm]	$\varnothing k$ [mm]	NxMxL	
95011-01-0032	32	42.4	140	43.0	10	18	100	4-M16x50	1.0
95011-01-0040	40	48.3	150	49.0	10	18	110	4-M16x50	1.2
95011-01-0050	50	60.3	165	61.0	10	18	125	4-M16x50	1.4
95011-01-0065	65	76.1	185	77.0	10	18	145	4-M16x50	1.7
95011-01-0080	80	88.9	200	90.0	10	18	160	8-M16x50	1.8
95011-01-0100	100	114.3	220	115.5	10	18	180	8-M16x50	2.0
95011-01-0125	125	139.7	250	141.5	10	18	210	8-M16x50	2.5
95011-01-0150	150	168.3	285	170.5	10	22	240	8-M20x50	3.0
95011-01-0155	150	152.0	285	154.0	10	22	240	8-M20x50	3.3
(95011-01-0175)	(175)	193.7	315	196.0	10	22	270	8-M20x50	3.5
95011-01-0200	200	219.1	340	221.5	10	22	295	8-M20x50	3.9

